

Alpha 1

AL20•20 (ABS Housing-Chrome), **AL20-20/BR** (ABS Housing-Brass),
AL20-20/B (ABS Housing-Black)



Technical Manual

CHARACTERISTICS

Every key of the “soft touch“-keypad is angled so the lettering of the key is readable even if looking from above. The integrated battery compartment in the bottom of the Alpha entry unit opens by moving a slider. Cable length is approximately 30 cm.

DIMENSIONS / MOUNTING INSTRUCTION

The diameter of the cable hole should be minimum 9 mm, maximum 12 mm. The hole must be deburred well to avoid damage to the cable.

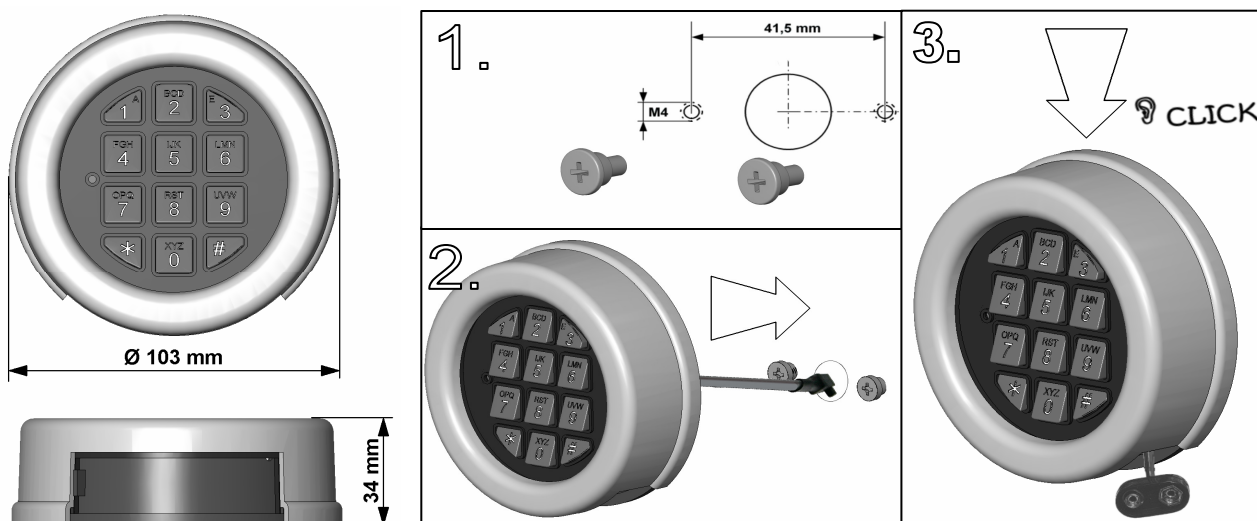

Affix the two mounting adapter (M4). Route the cable through the cable hole and slide the unit on the mounting adapters. The back of the unit must touch the door surface. Control cable routing, then push the unit down until it snaps on positively.

The Alpha entry unit can now not be removed!

Connect one (1) battery to the battery clip. Only use 9V-ALKALINE batteries from brand name manufacturers like DURACELL™.