

# EuroLine Compact

## KL15•60 Technical Manual



### CHARACTERISTICS

The EuroLine Compact series was specially developed for safes which have two thru holes, 100 mm apart. The plastic housing of the EuroLine KL15•60 combines a front reading dial with a large boltwork handle (metal). The set includes a 6mm square shaft for usage with lock ML67•40 as well as a 8x8 mm square shaft to drive the boltwork. The pictures show the most common usage but the unit can be used mirrored and also vertical.

### PREPARATION

#### 1. Mechanical Dial

Measure the distance (**D**) between the mounting surfaces of the dial and the lock (see picture below). Cut the shaft in one of the eight provided grooves. Use the table below to determine in which groove to cut. Do not leave more segments on the shaft than necessary. Normally no deburring is required.

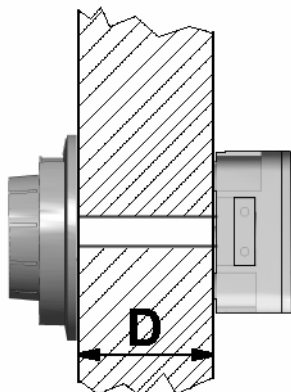

Distance (D) less than		Cut groove #
28 mm	1.1 inch	1
40 mm	1.6 inch	2
53 mm	2.1 inch	3
66 mm	2.6 inch	4
78 mm	3.1 inch	5
91 mm	3.6 inch	6
104 mm	4.1 inch	7
116 mm	4.6 inch	8

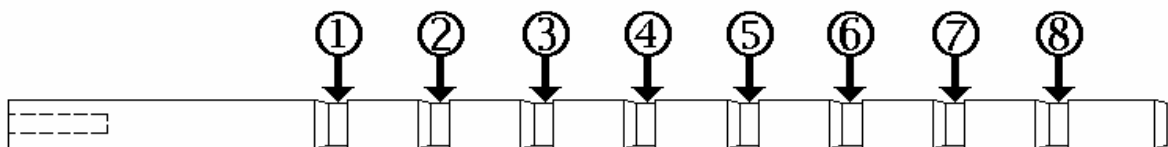

Affix the 6mm shaft with the provided screw in the dial and cover the screw with the small label. Discard the larger label.

## 2. Handle

Cut the 8 mm square shaft to an appropriate length. The shaft should stick out of the boltwork 5-8 mm and is secured by using the star washer. Assemble the handle as shown below. Affix the shaft in the handle with the provided screw and cover the screw with the label.

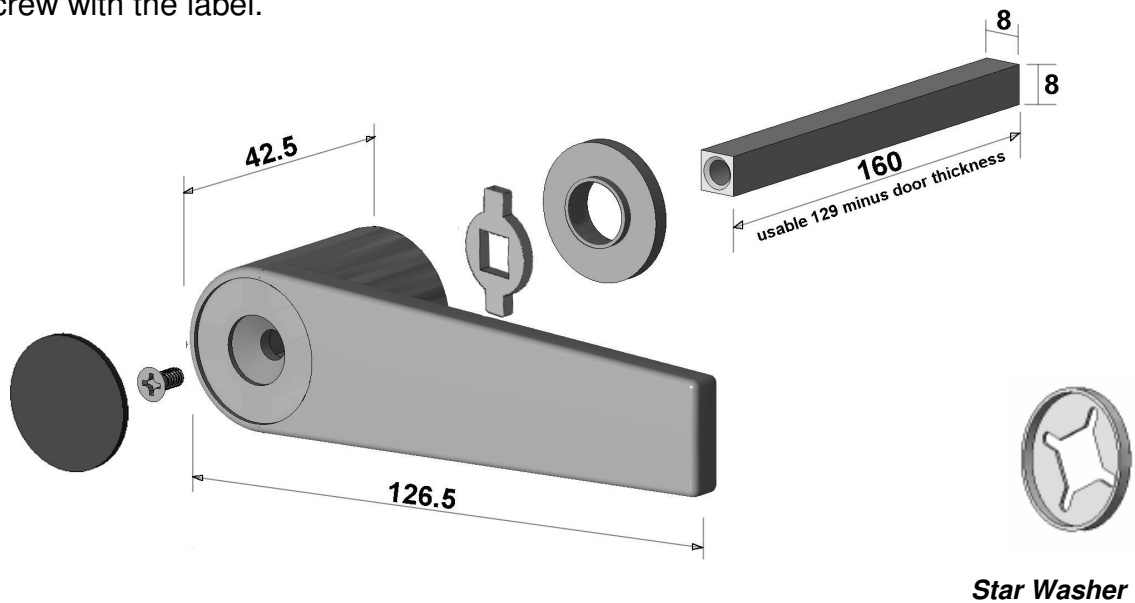

## DIMENSIONS

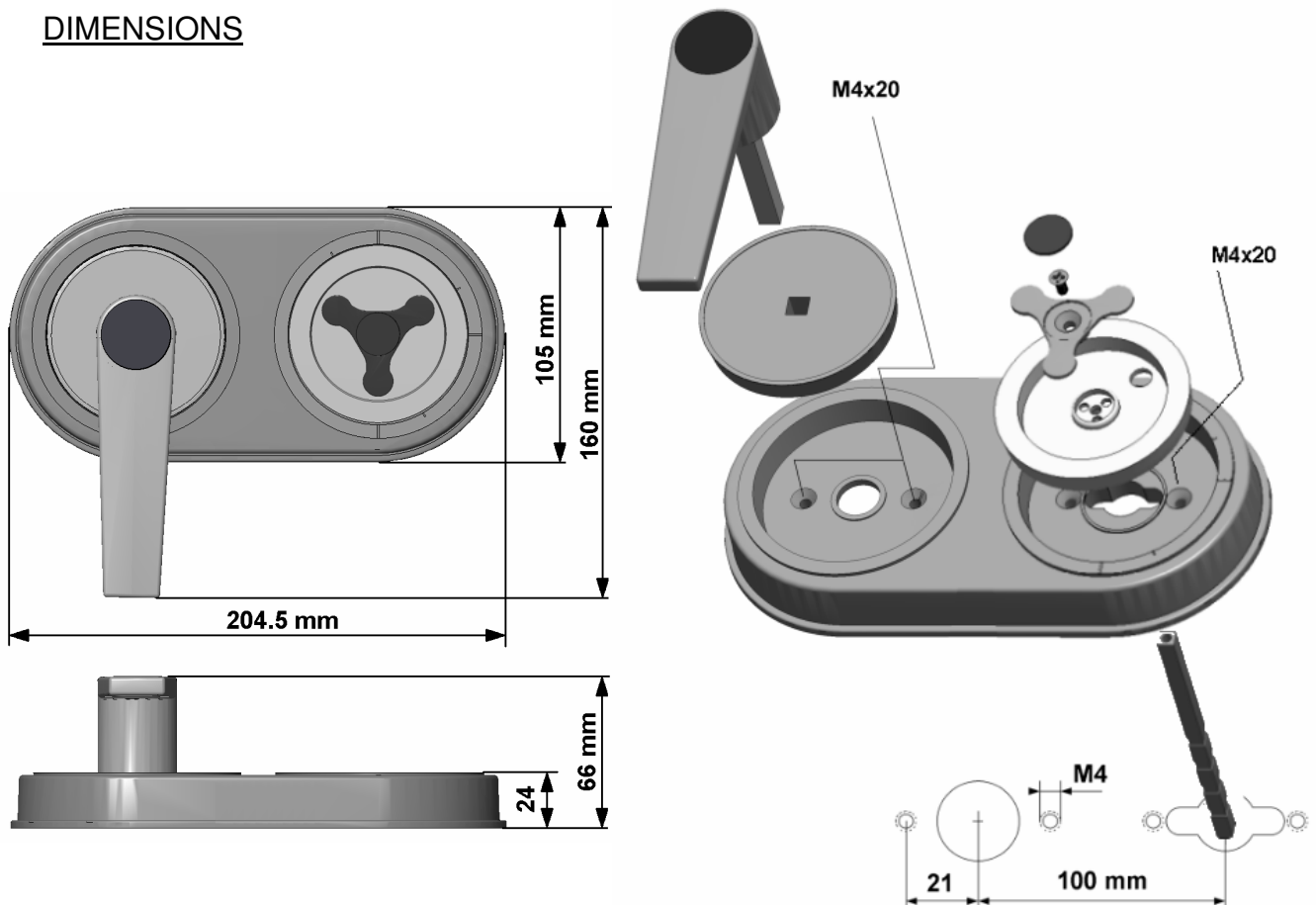

Adjust position and mount the housing with M4 (not included) flathead screws.  
Push the shaft as shown above into the boltwork. **Lock and boltwork must be in the “OPEN” position.**

Affix the 6mm shaft with the provided screw in the dial and cover the screw with the small label. Discard the larger label.

Install the ML67•40 lock first according to the installation instruction.

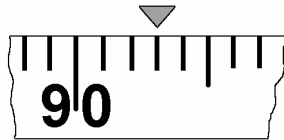

With the lock in OPEN position (bolt retracted) hold the dial in a way that approximately “93” is lined up with the opening index and push it into the lock.

**The shaft cannot be pulled out.**